

## 150/100 Amp Automotive Plug-In / PCB Power Relay

## PC7150



### FEATURES

- Most powerful automotive relay
- 1 A and 1 C contact forms available
- Contact switching capacity up to 300 Amps
- 150 Amps continuous carrying capacity
- Up to 125 degrees C operating temperature
- Available with diodes and or resistors
- Plain case or metal mounting bracket
- **Now available Lead Free & RoHS Compliant**

### CONTACT RATINGS

Contact Form	1 Form A or 1 Form C	
	Normally Open	Normally Closed
Max Switching Current	Make 300 Amps	Make 200 Amps
	Break 150 Amps	Break 100 Amps
Max. Switching Voltage	75 Volts DC	
Max. Continuous Current	150 Amps	100 Amps
Minimum Load	0.5 A @ 12 VDC	

### CONTACT DATA

Material	Silver Alloy	
Initial Contact Resistance	100 milliohms max @ 0.1A, 6VDC	
Service Life	Mechanical	1 X 10 <sup>7</sup> Operations
	Electrical	1 X 10 <sup>5</sup> Operations

### CHARACTERISTICS

Operate Time	10 ms. typical
Release Time	5 ms. typical
Insulation Resistance	100 megohms min, at 500VDC, 50%RH
Dielectric Strength	1,000 Vrms, 1 min. between coil and contacts
Shock Resistance	20 g, 11ms, functional; 200 g, destructive
Vibration Resistance	DA 1.27 mm, 10 - 40 Hz; 40-70 Hz: 5 g; DA 0.5mm, 70-100 Hz; 100-500 Hz: 10 g.
Drop Resistance	1 Meter height drop on concrete in final enclosure
Power Consumption	2.9 W approx.
Ambient Temperature Range	-40 to 125 degrees C operating, -40 to 155 storage
Weight	60 grams approx.

### ORDERING INFORMATION

Example:	PC7150	-1C	-C2	-12	S	-RN	-X
Model							
Contact Form	1A, 1C						
Case Style	C: Plain Case, C2: Metal Bracket						
Coil Voltage							
Enclosure	C: Dust Cover						
Parallel Component	Nil: None; D: Diode; R: Resistor; N: Nickel Plated Terminals						
RoHS Compliant	Nil: Not Rohs, -X: RoHS Compliant						

**COIL DATA**

Coil Voltage	Resistance ohms ± 10%	Must Operate Voltage Max. (VDC)	Must Release Voltage Min. (VDC)	Continuous Voltage Max. (VDC)
6	22	3.6	0.6	10.1
12	90	7.2	1.2	20.5
24	330	14.3	2.4	39.1

**Dimensions in Inches (millimeters)  
Plain Case Type**

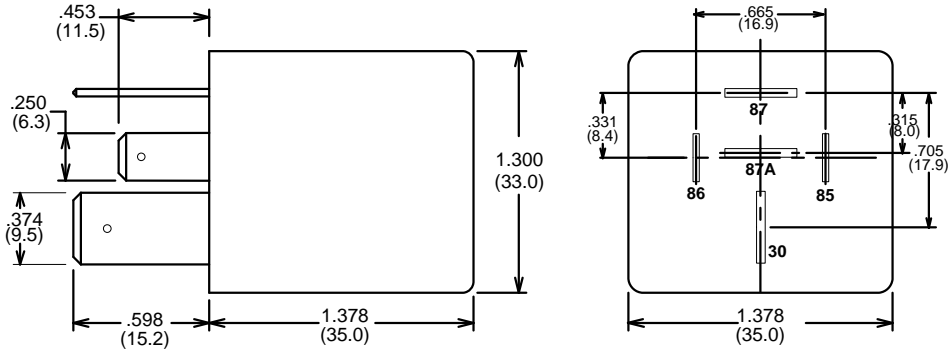

**Metal Bracket Type**

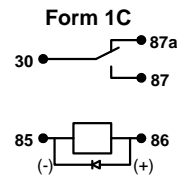
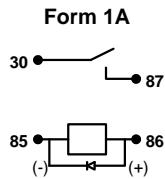
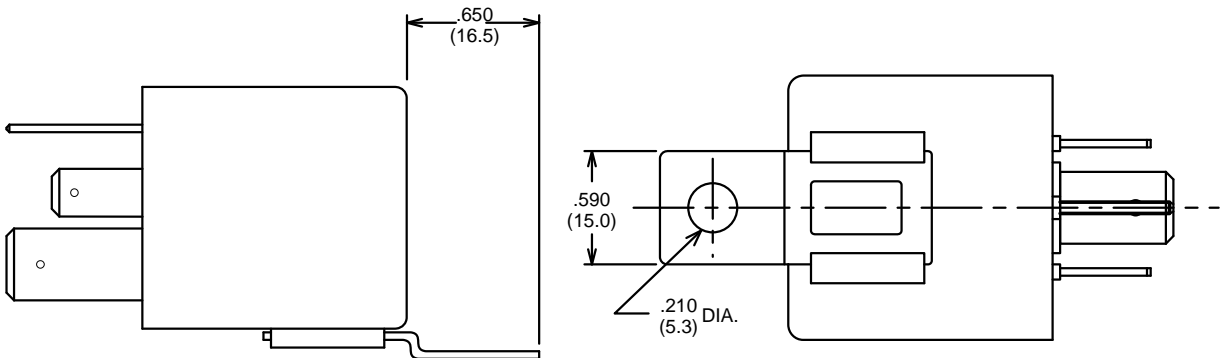

**Wiring Diagrams**

Notes:  
Tolerances ± .010 unless otherwise noted  
Maximum make current refers to inrush of a lamp load



3220 Commander Drive, Suite 102, Carrollton, Texas 75006

Sales: Call Toll Free (888) 997-3933 Fax (818) 342-5296 email: pickerwest@sbcglobal.net URL: pickercomponents.com