

Ultraminiature Automotive PCB Twin Power Relay

PC624

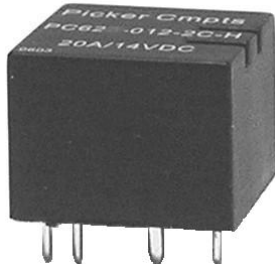

FEATURES

- Ultraminiature design very light weight
- Sensitive Coil (low pull in voltage) available
- Contact switching capacity up to 30 Amps
- Sealed, immersion cleanable
- Up to 85 degrees C operating temperature
- **Now available Lead Free & RoHS Compliant**

CONTACT RATINGS

Contact Form	2 X Form A or 2 X Form C 2 X SPST NO or 2 X SPDT
Max Switching Current	30 Amps
Motor Locked Rotor	25 Amps at 14 VDC
Max. Switching Voltage	16 VDC
Max. Continuous Current	25 Amps
Max. Switching Power	480 W

CONTACT DATA

Material	AgSnInO (Silver Tin Indium Oxide)	
Initial Contact Resistance	100 milliohms max @ 0.1A, 6VDC	
Service Life	Mechanical	1 X 10 ⁶ Operations
	Electrical	1 X 10 ⁵ Operations

CHARACTERISTICS

Operate Time	2.5 ms. typical (no coil suppression)
Release Time	1.2 ms. typical (no coil suppression)
Insulation Resistance	100 megohms min, at 500VDC, 50%RH
Dielectric Strength	1000 Vrms, 1 min. between coil and contacts
Shock Resistance	30 g, 6 ms, functional; 100 g, destructive
Vibration Resistance	6g, 10 - 500 Hz
Drop Resistance	1 Meter height drop on concrete
Power Consumption	0.60 W and 0.80 W
Ambient Temperature Range	-40 to 85 degrees C operating, -40 to 155 degrees C storage
Weight	10 grams approx.

ORDERING INFORMATION

Example:	PC624	-2C	-12	S	H	-X
Model						
Contact Form						
2A or 2C						
Coil Voltage						
Enclosure						
S: Sealed; C: Dust Cover						
Coil Power						
Nil: 0.60 W; H: 0.80 W						
RoHS Compliant						
Nil: Not RoHS, -X: RoHS Compliant						

COIL DATA

Coil Voltage	Resistance ohms ± 10%	Must Operate Voltage Max. (VDC)	Must Release Voltage Min. (VDC)	Coil Power Consumption (W)
12	225	6.9	1.0	0.60
12 (H)	180	5.8	1.0	0.80

Dimensions in Inches (millimeters)
Drawings are 2X actual size

Side View

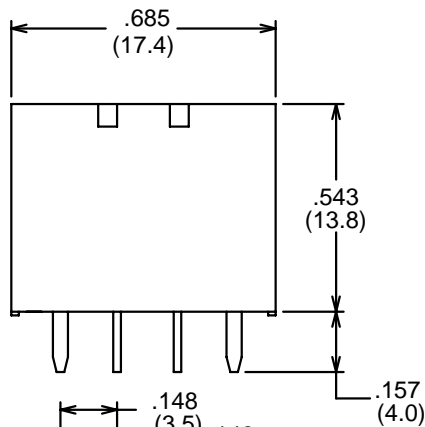

End View

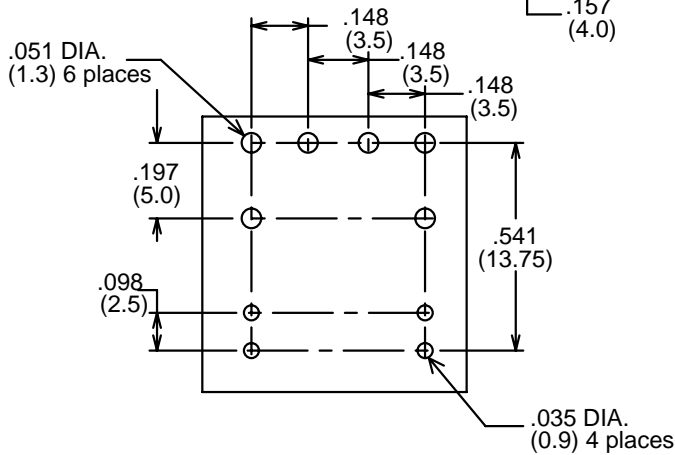
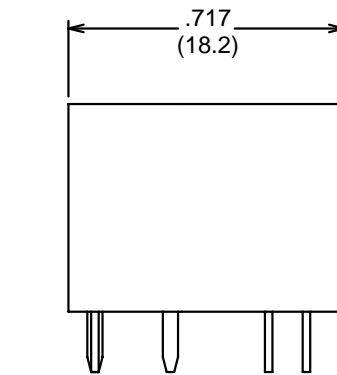

**Bottom View
PC Board Layout**

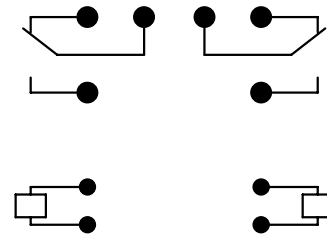

**Bottom View
Wiring Diagram**

Notes:
 Contact Form 2C shown
 On Contact Form 2A Unused Pin is Omitted
 Tolerances ± .010 unless otherwise noted



3220 Commander Drive, Suite 102, Carrollton, Texas 75006

Sales: Call Toll Free (888) 997-3933 Fax (818) 342-5296 email: pickerwest@sbcglobal.net URL: pickercomponents.com